

THE PLANNING OF THIS DEVELOPMENT AND THE DESIGN OF THE ARCHITECTURE AND THE LAYOUT OF THE BUILDINGS WILL BE SUBJECT TO THE REQUIREMENTS AND STANDARDS OF THE LOCAL AUTHORITY AND THE RELEVANT NATIONAL REGULATIONS AND STANDARDS.

DEVELOPABLE AREAS	
	VALLEY WOODLAND - 5.07 ha
	WESTERN WOODLAND - 1.77 ha
	VALLEY FLOOR - 2.26 ha
	PARKLAND - 2.80 ha
	WATERCOURSE APARTMENTS - 0.54 ha
	CARRIGHILL APARTMENTS - 1.05 ha
TOTAL SITE DEVELOPABLE AREA - 18.22 ha	
TOTAL SITE AREA (CUMULATED) - 21.90 ha	

LANDSCAPE AREAS	
	THE STEEP GRADIENTS AND TOPOGRAPHY
	THE WOODLANDS CONTAIN A TREE PROTECTION ORDER TO THE WEST/EAST OF THE SITE
	THE LOCATION OF THE EXISTING HIGH WATER WINDINGS
	THE CDP OBJECTIVE TO PROVIDE AN ENTRANCE TO THE EXISTING LOCAL ROAD NETWORK

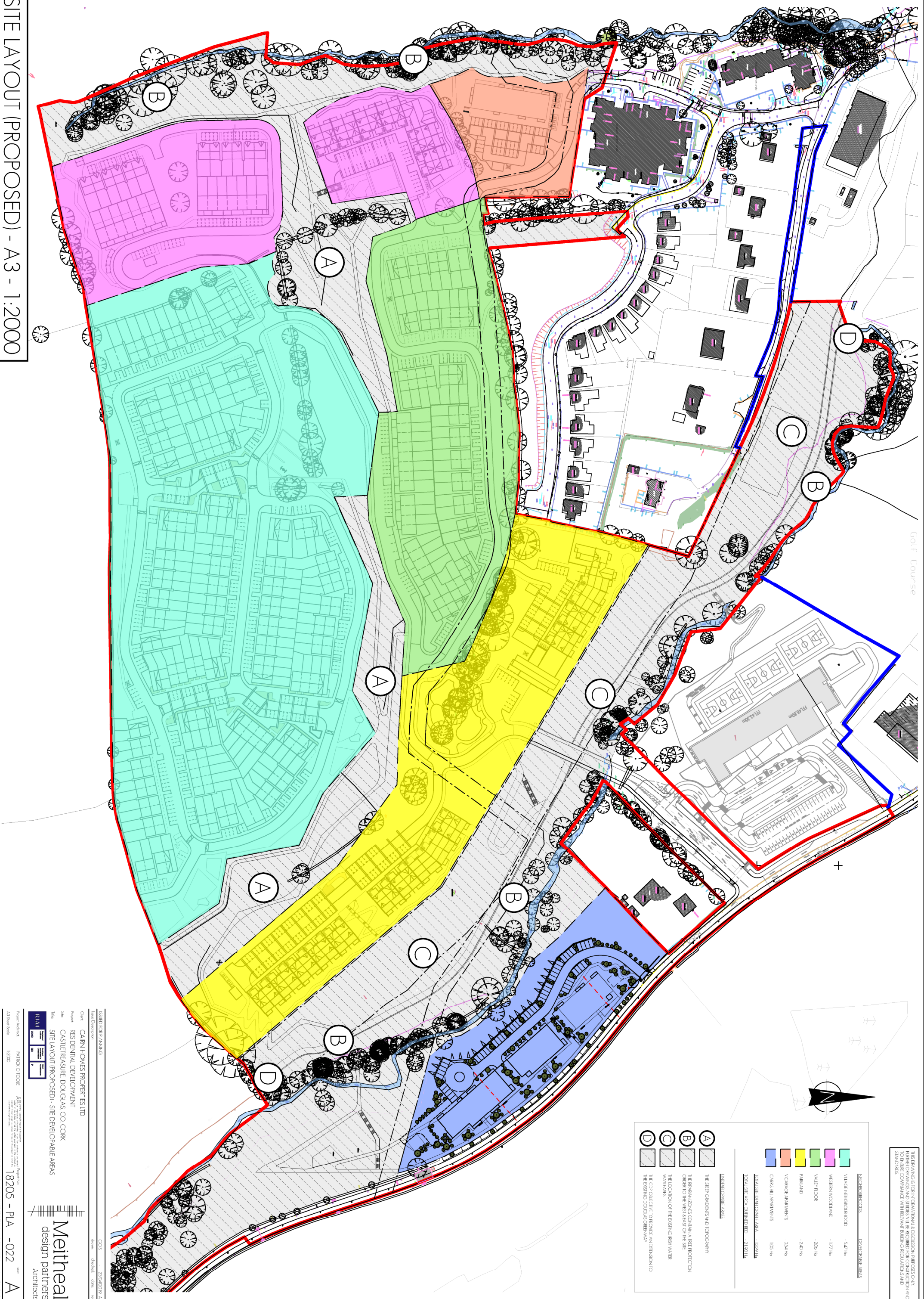

SITE LAYOUT (PROPOSED) - A3 - 1:2000

CLIENT: CAIRN HOMES PROPERTIES LTD
PROJECT: RESIDENTIAL DEVELOPMENT
SITE: CASTLEMEASURE DOUGLAS CO. CORK
TITLE: SITE LAYOUT (PROPOSED) - SITE DEVELOPABLE AREAS

DATE: 18/2024
SCALE: 1:2000

DESIGNER: Meitheal design partners Architects

PROJECT ARCHITECT: PATRICK O'LOUGHLIN
ARCHITECT: Meitheal design partners Architects
ADDRESS: 18, 20, 22, 24, 26, 28, 30, 32, 34, 36, 38, 40, 42, 44, 46, 48, 50, 52, 54, 56, 58, 60, 62, 64, 66, 68, 70, 72, 74, 76, 78, 80, 82, 84, 86, 88, 90, 92, 94, 96, 98, 100, 102, 104, 106, 108, 110, 112, 114, 116, 118, 120, 122, 124, 126, 128, 130, 132, 134, 136, 138, 140, 142, 144, 146, 148, 150, 152, 154, 156, 158, 160, 162, 164, 166, 168, 170, 172, 174, 176, 178, 180, 182, 184, 186, 188, 190, 192, 194, 196, 198, 200, 202, 204, 206, 208, 210, 212, 214, 216, 218, 220, 222, 224, 226, 228, 230, 232, 234, 236, 238, 240, 242, 244, 246, 248, 250, 252, 254, 256, 258, 260, 262, 264, 266, 268, 270, 272, 274, 276, 278, 280, 282, 284, 286, 288, 290, 292, 294, 296, 298, 300, 302, 304, 306, 308, 310, 312, 314, 316, 318, 320, 322, 324, 326, 328, 330, 332, 334, 336, 338, 340, 342, 344, 346, 348, 350, 352, 354, 356, 358, 360, 362, 364, 366, 368, 370, 372, 374, 376, 378, 380, 382, 384, 386, 388, 390, 392, 394, 396, 398, 400, 402, 404, 406, 408, 410, 412, 414, 416, 418, 420, 422, 424, 426, 428, 430, 432, 434, 436, 438, 440, 442, 444, 446, 448, 450, 452, 454, 456, 458, 460, 462, 464, 466, 468, 470, 472, 474, 476, 478, 480, 482, 484, 486, 488, 490, 492, 494, 496, 498, 500, 502, 504, 506, 508, 510, 512, 514, 516, 518, 520, 522, 524, 526, 528, 530, 532, 534, 536, 538, 540, 542, 544, 546, 548, 550, 552, 554, 556, 558, 560, 562, 564, 566, 568, 570, 572, 574, 576, 578, 580, 582, 584, 586, 588, 590, 592, 594, 596, 598, 600, 602, 604, 606, 608, 610, 612, 614, 616, 618, 620, 622, 624, 626, 628, 630, 632, 634, 636, 638, 640, 642, 644, 646, 648, 650, 652, 654, 656, 658, 660, 662, 664, 666, 668, 670, 672, 674, 676, 678, 680, 682, 684, 686, 688, 690, 692, 694, 696, 698, 700, 702, 704, 706, 708, 710, 712, 714, 716, 718, 720, 722, 724, 726, 728, 730, 732, 734, 736, 738, 740, 742, 744, 746, 748, 750, 752, 754, 756, 758, 760, 762, 764, 766, 768, 770, 772, 774, 776, 778, 780, 782, 784, 786, 788, 790, 792, 794, 796, 798, 800, 802, 804, 806, 808, 810, 812, 814, 816, 818, 820, 822, 824, 826, 828, 830, 832, 834, 836, 838, 840, 842, 844, 846, 848, 850, 852, 854, 856, 858, 860, 862, 864, 866, 868, 870, 872, 874, 876, 878, 880, 882, 884, 886, 888, 890, 892, 894, 896, 898, 900, 902, 904, 906, 908, 910, 912, 914, 916, 918, 920, 922, 924, 926, 928, 930, 932, 934, 936, 938, 940, 942, 944, 946, 948, 950, 952, 954, 956, 958, 960, 962, 964, 966, 968, 970, 972, 974, 976, 978, 980, 982, 984, 986, 988, 990, 992, 994, 996, 998, 1000